

EDRIC
THEATRE

EDRIC STUDIO 8

Technical Specifications

Updated: 01/10/25

(Floor plans for illustration only. Please contact for more accurate plans)

For any queries or for further information about the facilities please contact
edrictheatre@lsbu.ac.uk.

Edric Studio 8 Technical Specification

Please note that all details are subject to change. Inclusion of equipment in this specification does not guarantee its availability or that it is operational. Please confirm any requirements with technical staff at least 14 days prior to an event.

Contact details:

Technical Theatre Manager: Alan Power powera3@lsbu.ac.uk

Edric Theatre: edrictheatre@lsbu.ac.uk

Tel: 0207 835 8398

Address: 103 Borough Road, London. SE10AA.



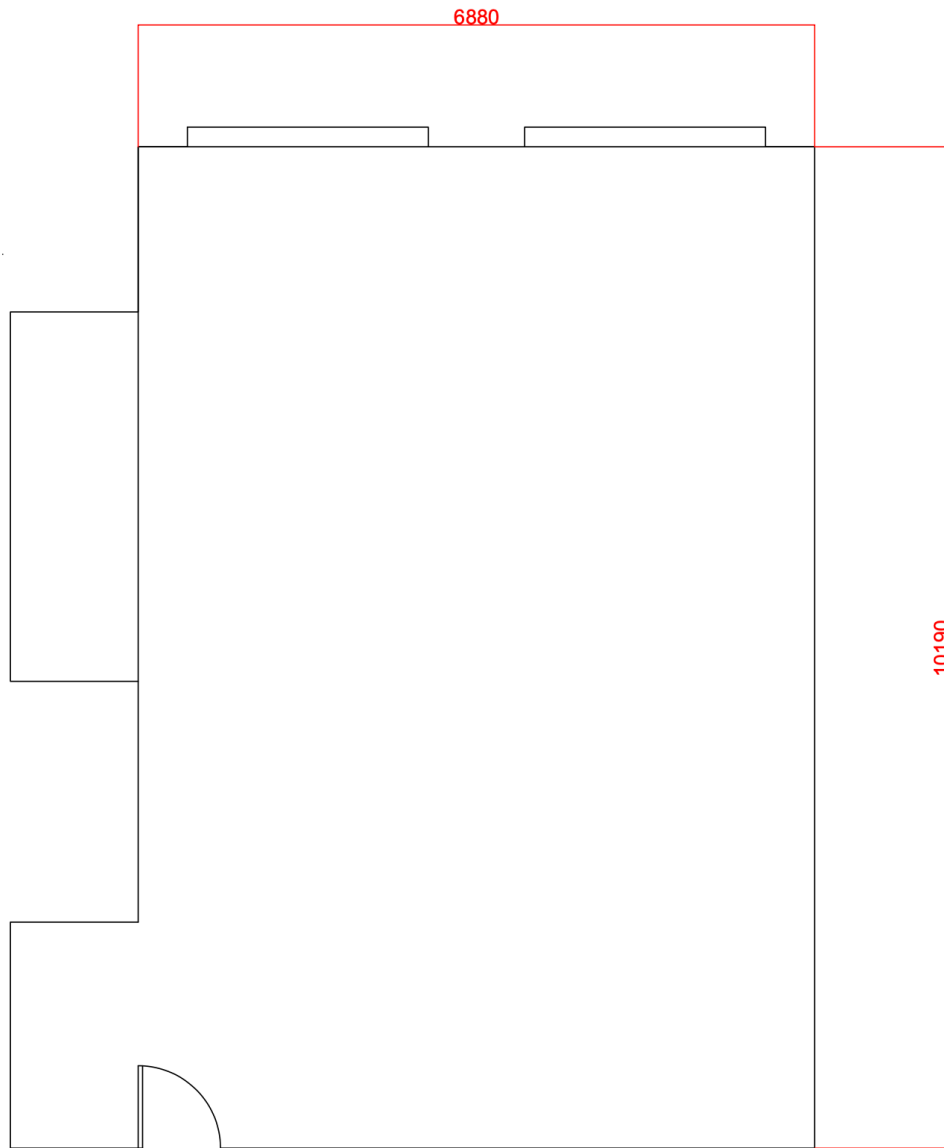

Dimensions: 6000 x 10000mm

Studio 8 is black box performance and rehearsal space with large windows. It has a grey sprung Harlequin dace floor, soft masking around all 4 walls.

Equipped with iMac and standalone projection system & 30 folding chairs

Lighting:

Control & Dimming:

- ETC Ion
- 2 X Universes
- 13 x Chauvet Eve P 160 RGBW
- 3 x Phillips Selecon PLprofile1
- A small selection of LED fixtures

Sound & AV:

- Yamaha QL1 Sound Desk
- Martin SX Series Speakers

Other Information:

Storage:

There is a small storage room to the side of the studio.

Load in / Parking:

Load in is either via stairs or small passenger lift. Dimensions and SWL TBC.

Our load in is neither easy nor convenient. If you're bringing in more than some furniture and a few stands please contact us in advance to discuss.

There is limited parking on Borough Road. Charges apply 8.30pm – 6.00pm Monday to Friday.

There is no on-site parking. Please check your arrangements before arrival. There are some local pay and display car-parks, but free parking is very limited in the area.

Load in is either from Borough Road or from a gated service road. If you are bringing a van please contact us and provide make/model, registration number and driver name. There is no parking so the van will need to be moved following load in.